



Vesttherm

HOT-WATER HEAT PUMP

HIGH QUALITY HOT WATER HEAT PUMPS

MODEL

VT3130 / VT3131 / VT3132

The heat pump exploits the energy of the air to heat the domestic water and is able to cover the annual consumption of an average family. It has a tank capacity of 270 litres and can produce up to approx. 800 litres of hot water per 24 hours. The heat pump is energy saving and makes it possible to save up to 65 percent of the expenses for hot water.

CONSTRUCTION AND EQUIPMENT:

- ✓ D-tube safety condenser precludes pollution of the domestic water with refrigerant and oil – no calcification of the condenser and so constant emission of heat.
- ✓ Heat coil for alternative operation.
- ✓ VT3132 with an extra heat coil for alternative operation e.g. solar heating.
- ✓ With \varnothing 160mm duct connections.
- ✓ Adjustable air quantity.
- ✓ 270 Litres, glazed steel tank equipped with a magnesium anode.
- ✓ PUR – hard foam insulation.
- ✓ Thermostatic, continuous variable control, permits an individual energy saving temperature setting.
- ✓ Working pressure 10 bar.



1. Air outlet
2. Evaporator
3. Compressor
4. Air inlet
5. Enamelled tank
6. Sensor pocket
7. Anode (upper)
8. Electrical heating element
9. Sensor pocket
- *10. Anode (lower)
11. Adjustable feet
12. Cold water inlet
13. Safety condenser
14. Insulation
15. Heating coil (lower)
16. Inlet heating coil (lower)
17. Outlet heating coil (lower)
18. Circulation branch
19. Hot water outlet
20. Defrost water outlet
21. Fan
- *22. Heating coil (upper)
- *23. Outlet heating coil (upper)
- *24. Inlet heating coil (upper)

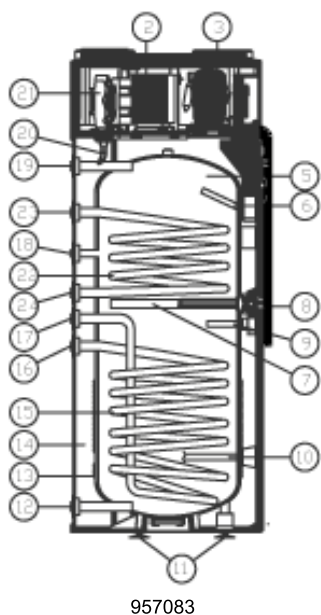

957083

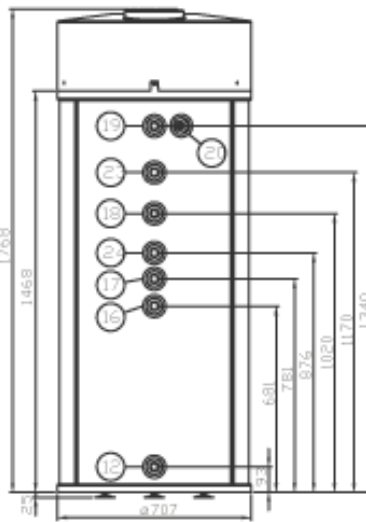

957083

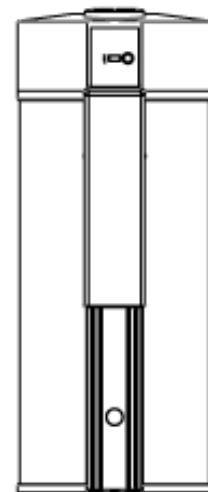

957083

25. Control button push/rotary
26. Control panel (Display)
27. Operating-/alarm lamp heat pump
28. Operating-/alarm lamp supplementary heating



957083

*Only VT3132

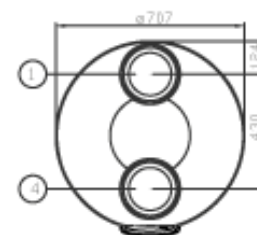

957083

Dimensions:

| | | |
|--------------------------------|-------------------|-------------|
| H x D | mm | 1768 x Ø707 |
| Voltage/frequency | Volt/Hz | 230/50 |
| Heat pump output | kW | 1,85* |
| Heat pump input | kW | 0,55* |
| Heating element | kW | 2,0 |
| Max output | kW | 3,85 |
| Water temperature | °C | 5-55 |
| Working air temperature VT3131 | °C | -10 / +35 |
| Quantity of air | m ³ /h | 200/300 |
| Boiler VT3130 | L | 270 |
| Boiler VT3131 | L | 258 |
| Boiler VT3132 | L | 242 |

| | | |
|--------------------------------|----------------|---------------|
| Working pressure max | bar | 10 |
| Refrigerant R134a | kg | See Nameplate |
| Heating coil – surface: | | |
| VT3131 | m ² | 1,00 |
| VT3132 | m ² | 0,6 + 1,5 |
| Weight empty | kg | 130-150-170 |
| Hot and cold heat exchanger | thread | 1" |
| Circulation | thread | 3/4" |
| Defrost water | thread | 1/2" |
| Climate class | | SN |

| | | |
|--------------------------------|----------------|---------------|
| Working pressure max | bar | 10 |
| Refrigerant R134a | kg | See Nameplate |
| Heating coil – surface: | | |
| VT3131 | m ² | 1,00 |
| VT3132 | m ² | 0,6 + 1,5 |
| Weight empty | kg | 130-150-170 |
| Hot and cold heat exchanger | thread | 1" |
| Circulation | thread | 3/4" |
| Defrost water | thread | 1/2" |
| Climate class | | SN |

| | | |
|--------------------------------|----------------|---------------|
| Working pressure max | bar | 10 |
| Refrigerant R134a | kg | See Nameplate |
| Heating coil – surface: | | |
| VT3131 | m ² | 1,00 |
| VT3132 | m ² | 0,6 + 1,5 |
| Weight empty | kg | 130-150-170 |
| Hot and cold heat exchanger | thread | 1" |
| Circulation | thread | 3/4" |
| Defrost water | thread | 1/2" |
| Climate class | | SN |

* At an temperature of +20°C - 70% RH and heating of the water from 15°C to 47°C.

Installation:

The heat pump is compact delivered, ready assembled with wire for connection to a socket. The hot- and cold water pipes are connected to the heat pump according to the present rules (safety

group is not included). An outlet for the melt water is provided. The tank is filled with water and the heat pump is then ready for use.



Vesttherm A/S
 Høgevej 9
 DK-6705 Esbjerg Ø
 Denmark
 Phone +45 7514 0244
 Fax +45 7514 4818

www.vesttherm.com